

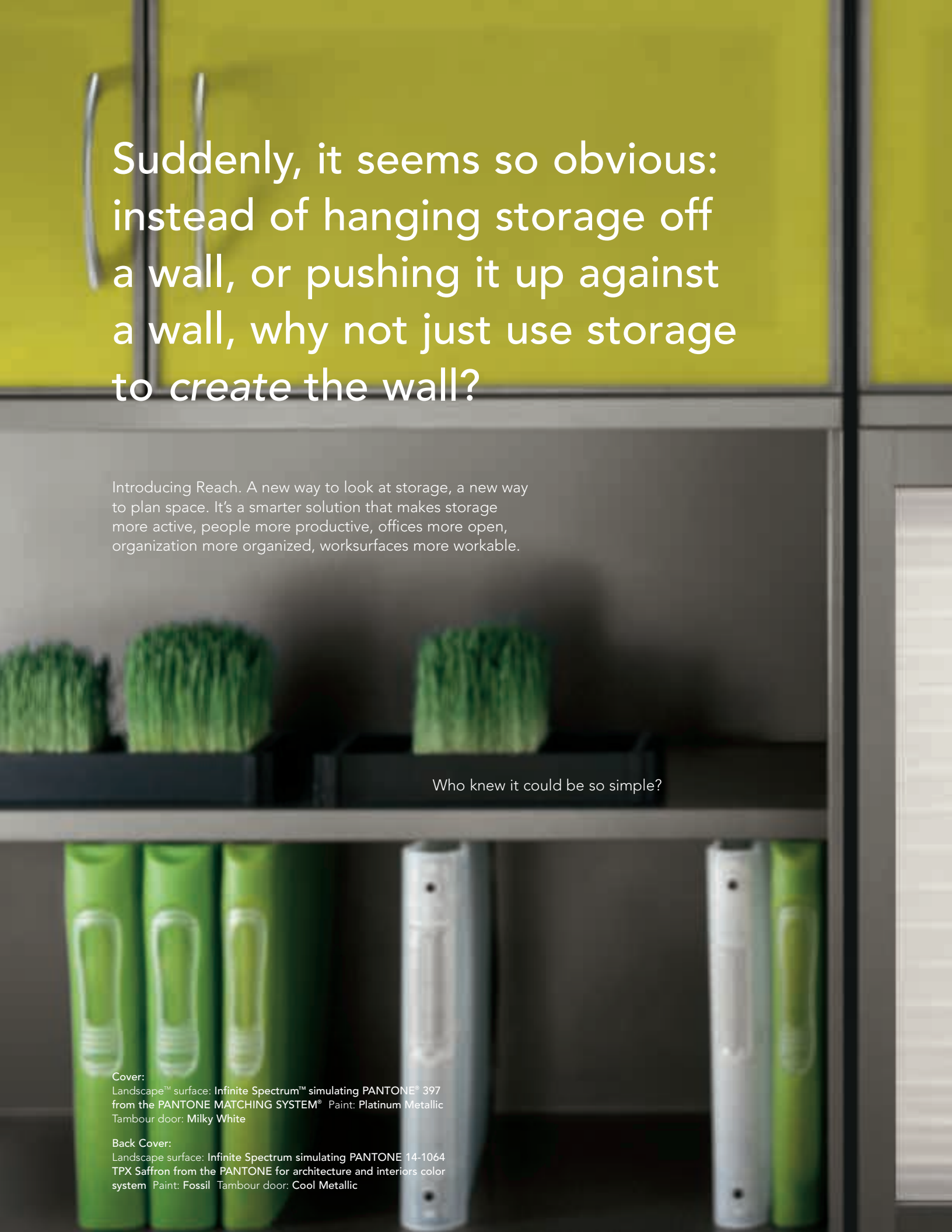

Allsteel[®]

Designed to work. Built to last.

Reach[™]



Suddenly, it seems so obvious:
instead of hanging storage off
a wall, or pushing it up against
a wall, why not just use storage
to *create* the wall?

Introducing Reach. A new way to look at storage, a new way to plan space. It's a smarter solution that makes storage more active, people more productive, offices more open, organization more organized, worksurfaces more workable.

Who knew it could be so simple?

Cover:

Landscape™ surface: Infinite Spectrum™ simulating PANTONE® 397 from the PANTONE MATCHING SYSTEM® Paint: Platinum Metallic
Tambour door: Milky White

Back Cover:

Landscape surface: Infinite Spectrum simulating PANTONE 14-1064 TPX Saffron from the PANTONE for architecture and interiors color system Paint: Fossil Tambour door: Cool Metallic





No storage under desk
means lots of legroom
and space to move around.

Plenty of storage lets you
reclaim worksurface space
for work.



Opposite-facing offices
share a single storage wall.

A better office is now within Reach.

Reach creates offices that are easier to get and keep organized. By placing high-capacity storage right in the wall, everything is suddenly at arm's length. With files and piles, peripherals and electronics out of the way, your desk becomes one open, continuous worksurface. Because there's nothing overhead or under the desk, you have a more comfortable range to work. Reach lets you stash things more neatly, think thoughts more clearly, and stretch yourself more fully. All of which lets you accomplish more, more easily.







Reach as a wing wall creates offices for people with maximum storage requirements.

Use the same surfaces and finishes for Terrace and Reach and create a single, seamless aesthetic throughout the office.

A variety of worksurface shapes surround people with a workable desktop and let you make optimal use of the spine wall.

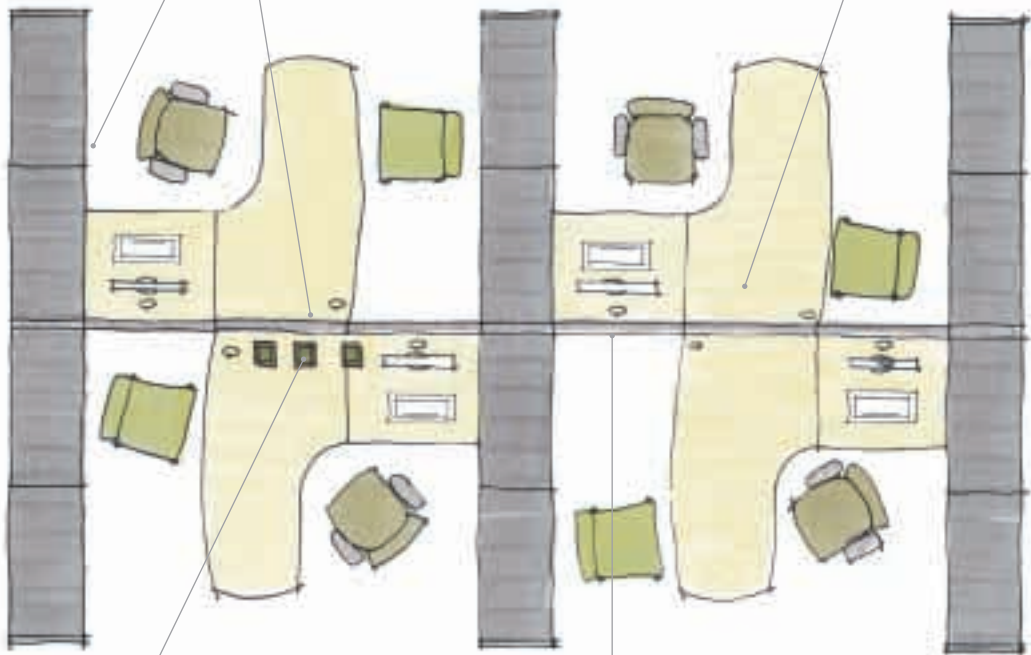

Greenery and flowers have been proven to improve attitude and productivity.

With Terrace 2.6 as a spine wall, you gain extra planning flexibility.

Opposite: Reach integrated with Terrace® 2.6

Landscape surface: Infinite Spectrum simulating PANTONE 397 from the PANTONE MATCHING SYSTEM Panel fabric: Tempest Sandstorm Cleargrain™ veneer: Natural Maple Paint: Fossil Tambour door: Milky White Seating upholstery: Maharam Flora 426, Tiny Check Willow Frame finish: Black, Tungsten Metallic

High-tech, high-touch, high-five.

Reach creates a new kind of office, a new way to work. A custom, two-sided storage wall with files, shelves, doors, and drawers of many shapes and sizes makes offices that are more versatile, organization that's more flexible. Power and data access can be located at the baseline, beltline, and within the storage modules for powering up equipment that used to take up desk space. A wide variety of colors, textures, finishes, and Landscape surfaces makes a design statement. And there's always plenty of room for items that make a statement of self.



Green fact: Reach metal storage units contain 25% post-consumer recycled content and are easily disassembled for post-use recyclability. Reclaimed textured black paint is used on drawer interiors.

The right storage in the right place.



Reach features storage, including drawers and shelves of various depths, on both sides of the wall. Lockable lateral files safely store those projects being kept for posterity.







A world without panels provides maximum storage in a minimalist floorplan.

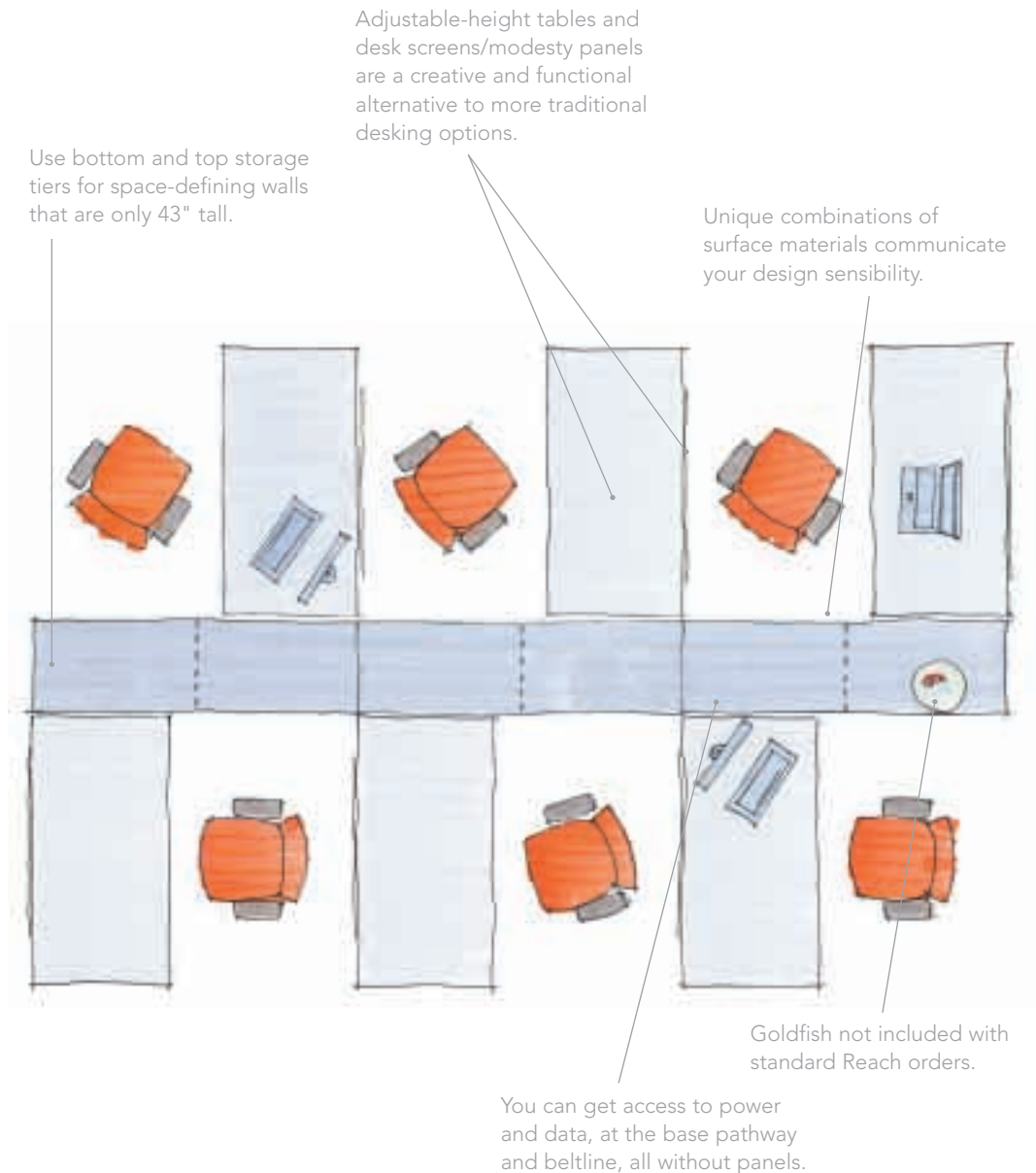

Opposite: Reach integrated with Ahrend 500 tables and S2 screens

Landscape surface: Infinite Spectrum simulating PANTONE 14-1064
TPX Saffron from the PANTONE for architecture and interiors color
system Worksurface: Light Grey melamine on Ciranol Desk screen:
Semi-Transparent Paint: Platinum Metallic Seating upholstery:
Maharam Flora 586 Frame finish: Black

Bring down the walls.

Reach can stand on its own in open, design-driven environments. Gain a new perspective on space with storage units that make offices materialize from the ground up. Integrate freestanding furniture that defines workspaces without fencing them in. Organize teams around functions and let space speak for itself. You'll improve everyone's view.

 **Green fact:** Reach maximizes access to daylight, meeting LEED® requirements and improving productivity.

Don't let a good idea get away.



Reach does double and triple duty with worksurfaces on top and open shelving on the sides, giving you plenty of space to sketch, share, and store all your great ideas.







With so much storage, sharing space is never a problem.

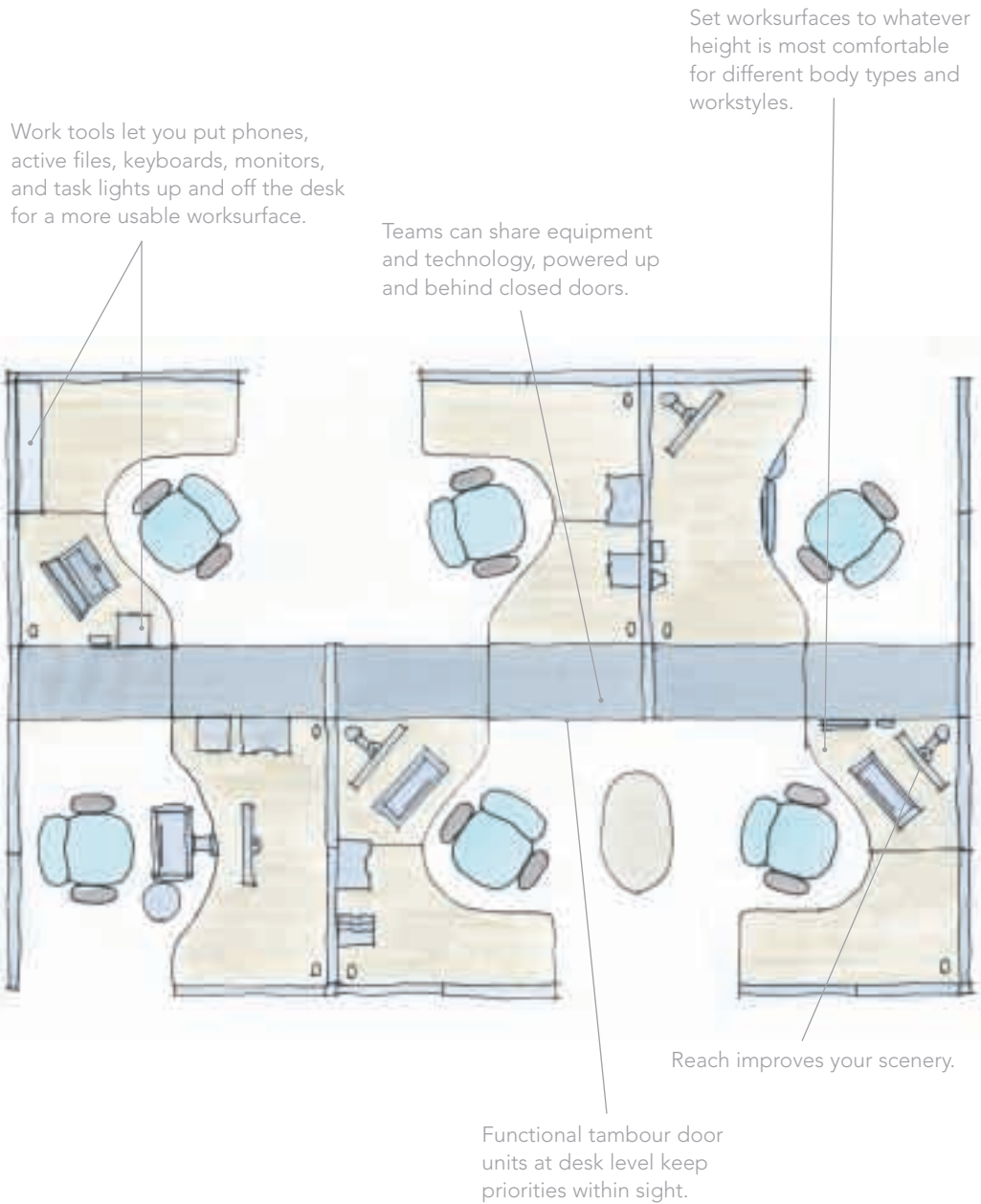

Opposite: *Reach integrated with Terrace 2.6*

Landscape surface: Pearlescent Strata™ Glacier, Tech Metal Tool Panel
fabric: Celestial Linen Laminate (edge): Pearl Bisque (Muslin) Paint:
Platinum Metallic Tambour door: Milky White Seating upholstery:
Sockhop Blue Moon Frame finish: Black

One plus one makes three.

Reach creates a single space with plenty of storage where people can work individually and as a team. Worksurfaces can be set at any height to accommodate every kind of workstyle. Equipment can be shared and kept out of sight. Get Set™ tables roll in as work expands. And because panels aren't supporting storage, they can be lower. Which improves the flow of air, light, and perhaps most important, ideas.

 **Green fact:** Reach is designed to be durable for many years of use and re-use, which benefits the environment by saving raw materials required to make new products.

Behind the scenes, close at hand.



A roll-out shelf and power within the storage compartment let you stash printers and gadgets so they're not taking up valuable workspace. Additional side shelves get the files and piles off the desk, while keeping them top of mind and within arm's reach.

The office for how people work, today.

The way we work is changing. Styles are fluid, with teams shifting to fit the task at hand. New technologies keep people connected to work and each other, yet we hold onto more paper than ever before. Rising costs and flattened corporate structures have companies compressing space and moving from private offices to the open plan while considering how space should be allocated between primary offices, teaming areas, and amenity spaces. But the things that we value in our work environment have not changed: comfort, communication, access to people and information, and workspaces that are organized, functional, and efficient.

Reach addresses the primary concerns of today's office by looking at storage and space in a whole new way.

Start with the bottom storage unit. Then make the wall your own by choosing middle and top levels of storage, with shelves, drawers, and compartments specific to your needs.



Storage becomes the wall and the wall becomes storage.



Overhead cabinets and pedestals now work together as a single wall of storage. The storage wall becomes the foundation for a set of opposite-facing offices.

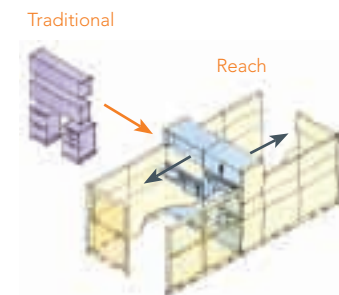

With built-in storage and no overheads, Reach maximizes access to daylight, meeting LEED requirements and improving well-being.

Worksurfaces are clear and open, so they look better and work harder. Plus, worksurfaces can be installed at any height—from sitting to standing—to accommodate different workstyles and fit the individual.



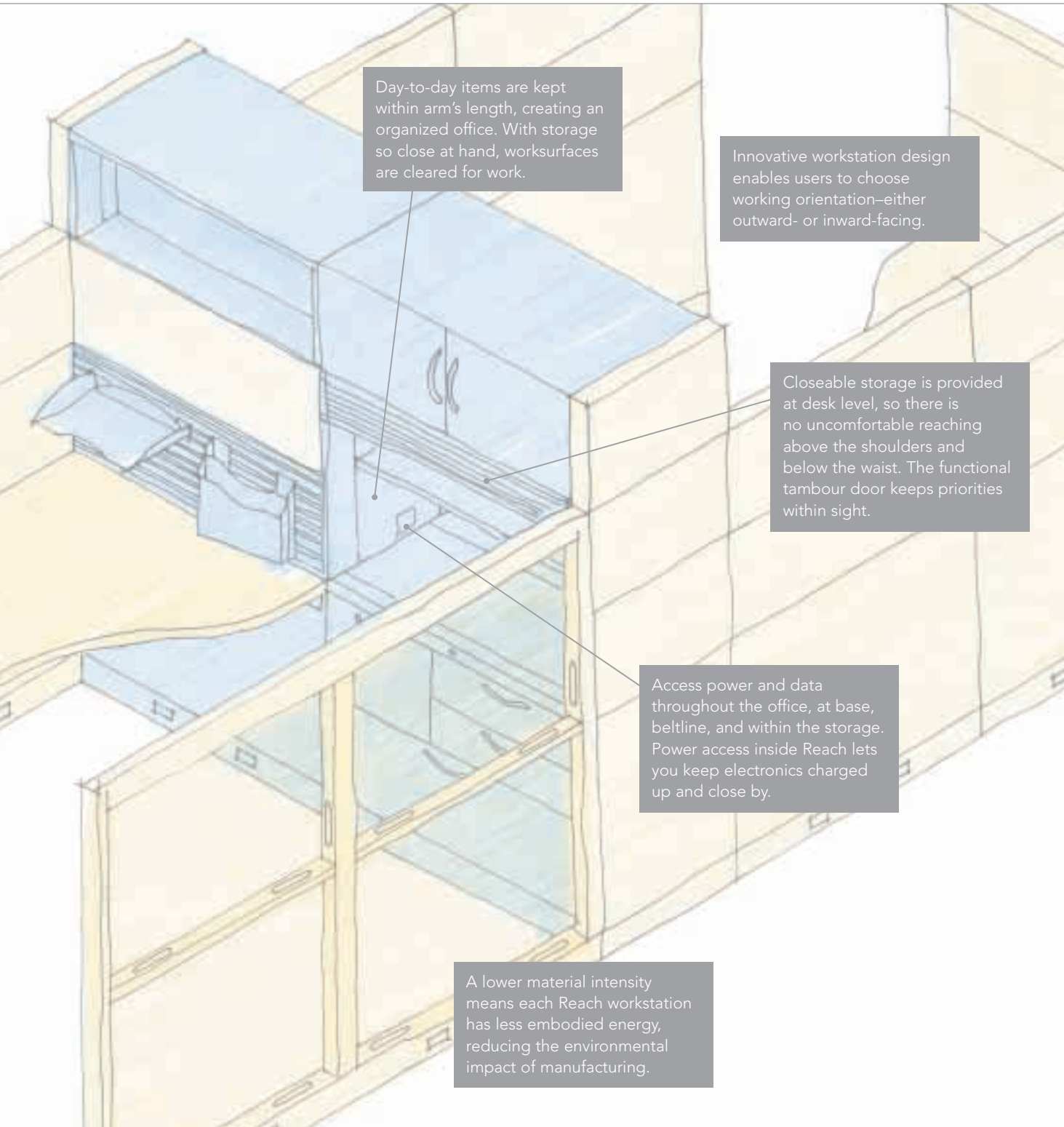

Day-to-day items are kept within arm's length, creating an organized office. With storage so close at hand, workspaces are cleared for work.

Innovative workstation design enables users to choose working orientation—either outward- or inward-facing.

Closeable storage is provided at desk level, so there is no uncomfortable reaching above the shoulders and below the waist. The functional tambour door keeps priorities within sight.

Access power and data throughout the office, at base, beltline, and within the storage. Power access inside Reach lets you keep electronics charged up and close by.

A lower material intensity means each Reach workstation has less embodied energy, reducing the environmental impact of manufacturing.

Stack up storage and start discovering more space.

With a smart and innovative design, Reach achieves more with less. Because Reach is so efficient, a more compact office actually feels bigger and works harder. As a result, Reach frees space in all directions, within each workstation and across the entire office floorplan.

The typical way to space plan.

8' x 8' Traditional Workstation

22 cu. ft. of storage

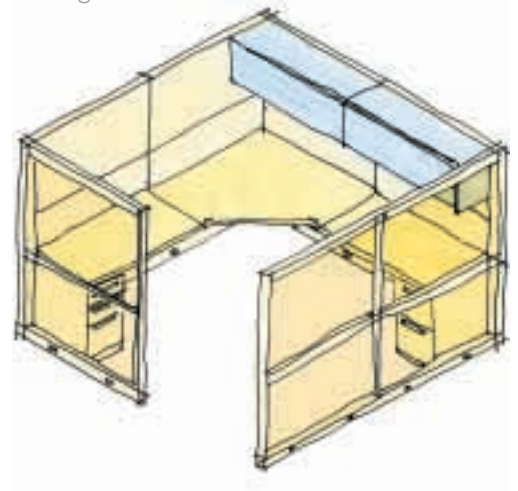

Realize the savings.

Examples of what you can do with the space saved when using Reach in a typical medium-sized office with 144 workstations:

Hire more staff.

Up to 33% density improvement.

Add 48 additional workstations.

Expand teaming area.

Double your collaboration space.

Add 4,000 sq. ft.

Cut real estate costs.

Achieve significant savings.

\$110,943 saved per year.*

*\$24/sq. ft. full-service gross rental rate, with all saved square footage unrented and not used for other purposes.

8' x 8' Traditional Workstations
(using overhead cabinets and pedestals)

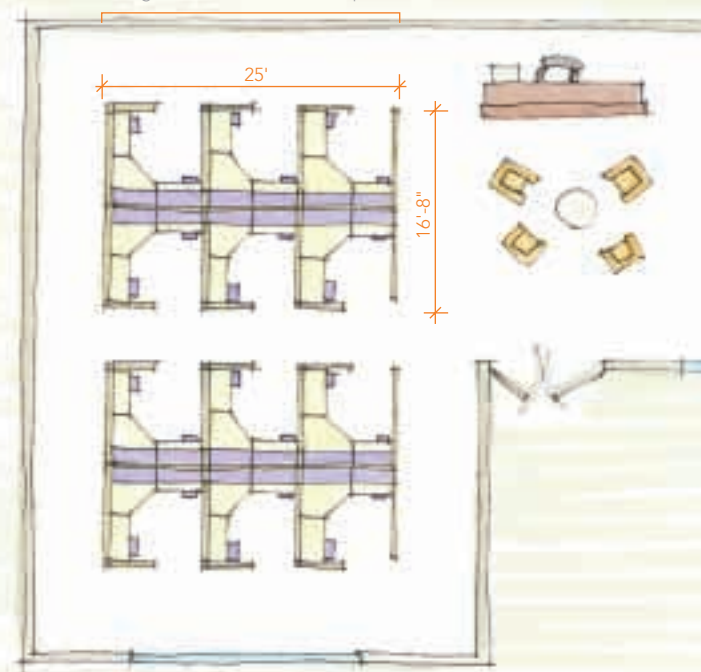

More office in 25% less space.

6' x 8' Reach Workstation

24 cu. ft. of storage

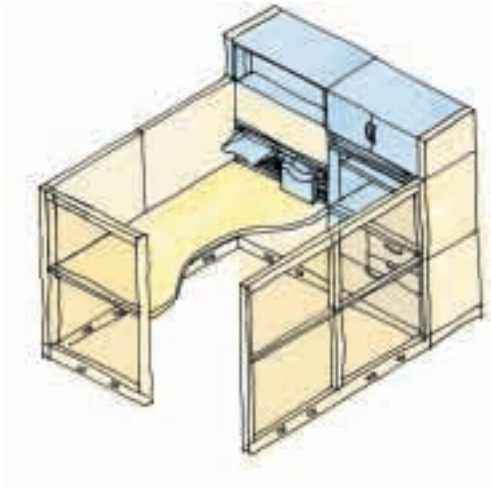

Utilize your space more wisely.

Move from 8' x 8' traditional workstations to 6' x 8' Reach workstations, and workspace and floor space become more functional, comfortable, and productive.

More with less.

Eight Reach workstations fit in a slightly smaller footprint than six traditional workstations.

Additional floor to plan.

7" of gained space per cluster can be used for wider aisles, an additional bank of lateral storage, a larger teaming area.

6' x 8' Reach Workstations

8' x 8' Reach Manager Workstations

Saved space can become a training and conferencing area

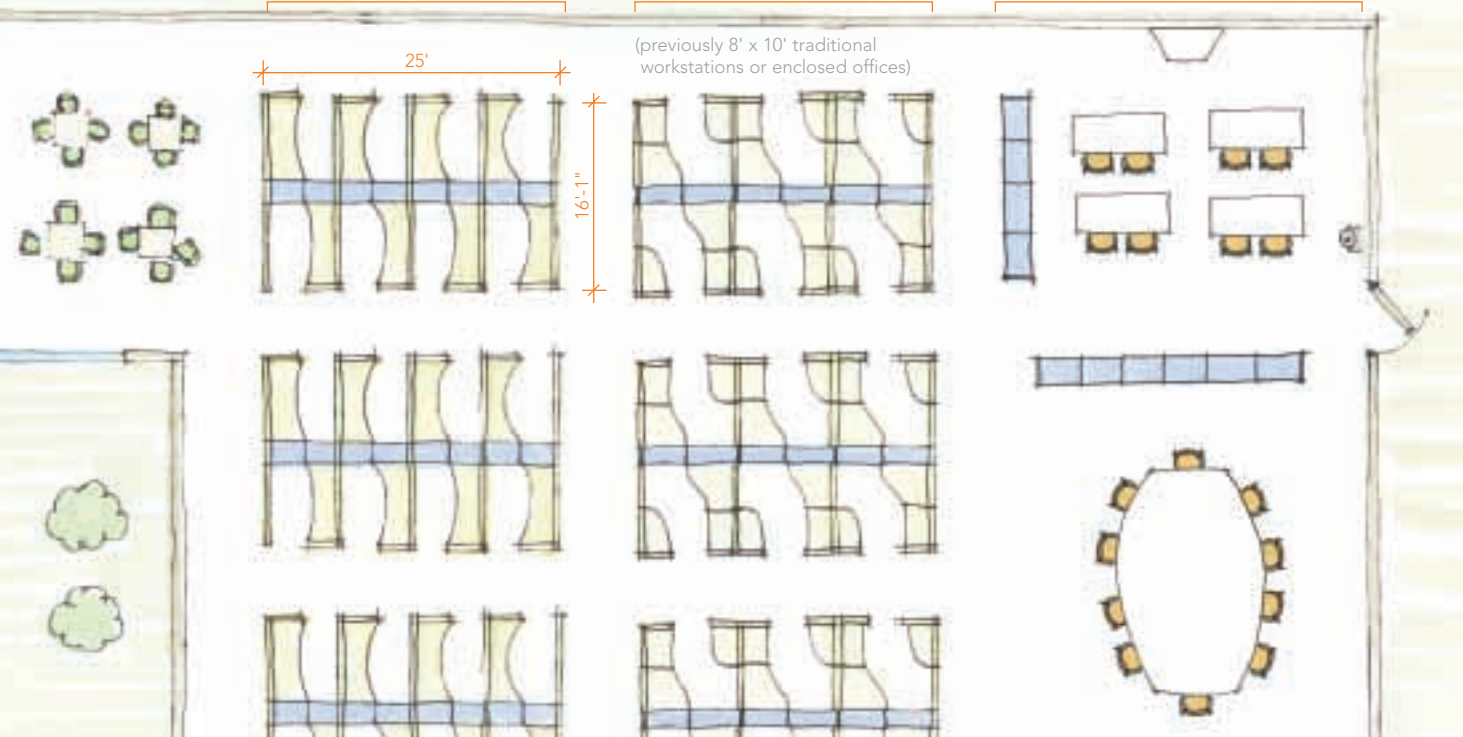







Compact offices that feel big.

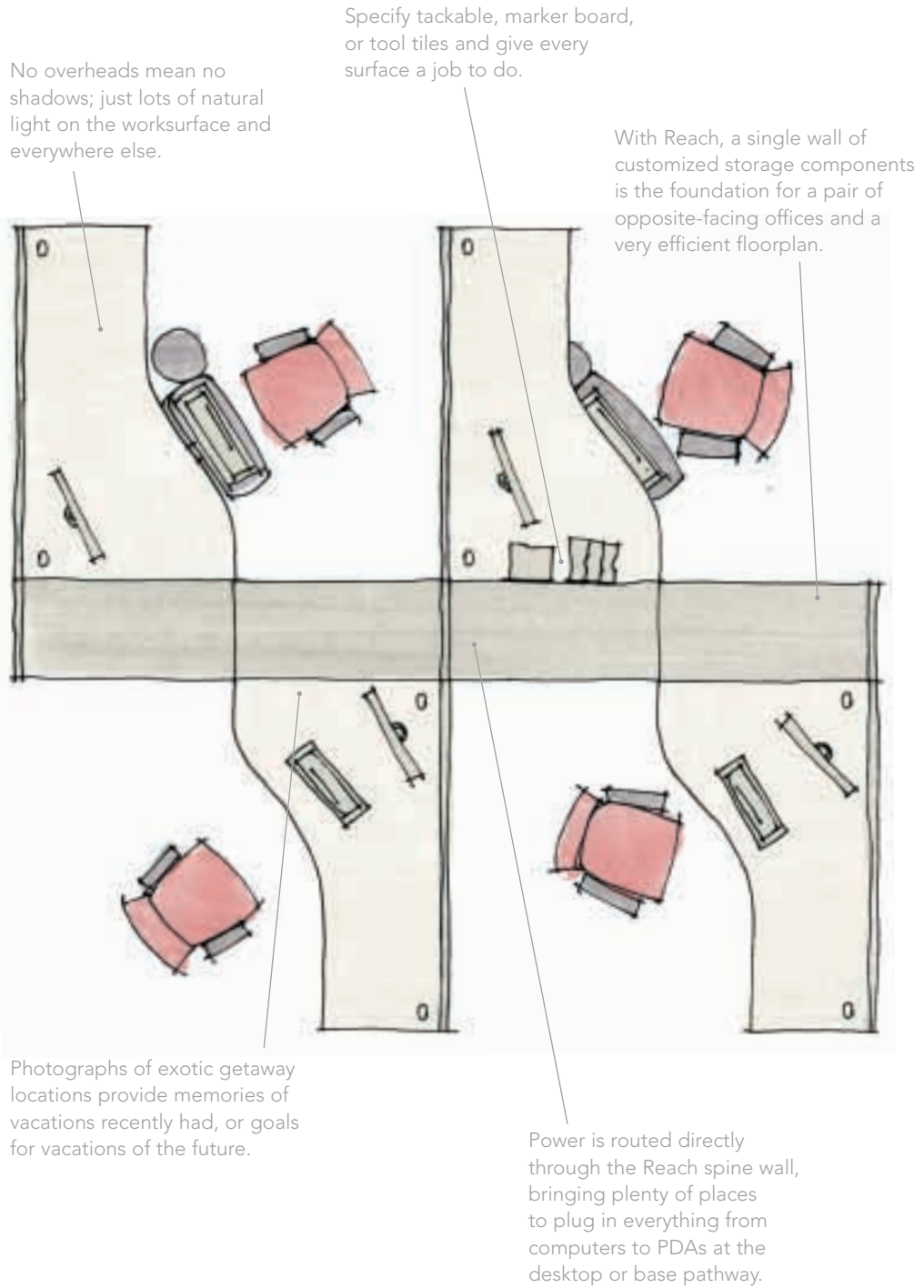

Opposite: *Reach integrated with Adept™*

Divider material: Luna Odeon Bibolet (COM), Pearl Bisque Panel fabric: Luna Odeon Bibolet (COM) Laminate (edge): Whitestone (Muslin) Paint: Champagne Metallic Tambour door: Milky White Seating upholstery: Maharam Precisely Brick (COM) Frame finish: Black

Light in scale and full of light.

Pair Reach with Adept dividers and you let each component play to its strengths. Reach as the spine wall provides plenty of personalized storage along with ample plug-and-play power capacity, while Adept uses its light touch to divide space and create privacy. Add a rudder-shaped worksurface and you get a computer corner along with ample area for writing, planning, even conferring with colleagues. And at only 56" high and without overheads, this two-sided space lets in lots of natural light, which gives everything and everyone a sunnier point of view.

 **Green fact:** Reach contributes to cleaner air for employees by meeting the LEED for Commercial Interiors requirements for indoor air quality.

A perfect match.



Reach and Adept come together easily, with simple attachment and few parts and pieces. All of which simplifies installation and inventory management, which helps simplify overall space planning.







Beauty, brains, and brawn, all in one place.

Full-depth, under-desk, open shelving maximizes every inch of storage opportunities.

Use Terrace 3.4 as the spine to create a space that gives everyone easy, anywhere access to power/data.

Even the backside of Reach makes a contribution to the office environment: choose tiles in fabric, marker board, or Landscape surfaces to fully integrate aesthetics inside and outside individual workstations or teaming areas.

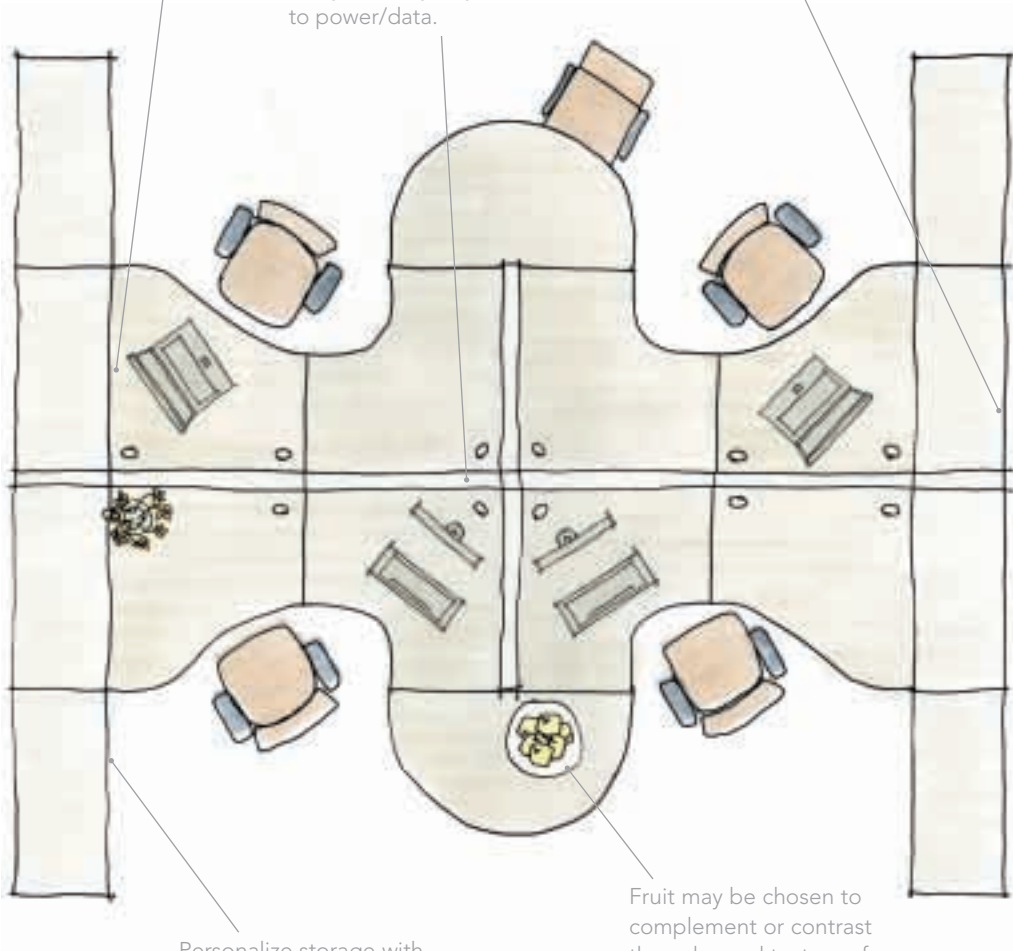

Personalize storage with any number of drawer and shelf configurations.

Fruit may be chosen to complement or contrast the color and texture of your office environment.

Opposite: Reach integrated with Terrace 3.4

Landscape surface: Infinite Spectrum simulating PANTONE 14-1025 TPX from the PANTONE for architecture and interiors color system
Panel fabric: Maharam Messenger Rattan Laminate (edge): Whitestone (Muslin) Paint: Muslin Tambour door: Milky White Seating upholstery: Infinity Sandstone Frame finish: Black

Works hard, and looks good doing it.

Use Reach with Terrace 3.4 and increase not only your storage, but your cable management capacity, too. The generous width of Terrace 3.4 allows you to run more cables to more places, so you can have power and data at the desktop, base pathway, or at any 13" increment on the frames. Cables can continue right into the Reach wing walls, for inside-storage plug-in capabilities. And all this cabling capacity comes in a beautiful package, with the substantial, architecturally styled frame of Terrace 3.4 a perfect complement to Reach's sophisticated detailing.

 **Green fact:** Reach's environmental footprint is 14% less than traditional workstations using the same floor space.

Hidden in plain sight.



Now under-desk space is no longer wasted space. Full-depth, open shelving gives you the perfect spot to store those things you want close by, but not necessarily front-and-center. Binders, reports, paper supplies, even your gym bag, are now easy to put away, and easy to get at.



Now that there's a place for everything, you'll find yourself in a calm oasis of more organized, effective, and efficient productivity. But just as important, you'll be more comfortable.

All of which will improve your perspective.

Reach integrated with Terrace 2.6

Landscape surface: Infinite Spectrum simulating PANTONE 15-1217 TPX from the PANTONE for architecture and interiors color system, Mulberry Paper Mojave Panel fabric: Metallation Etched Bronze, Propeller Sandalwood Cleargrain veneer: Light Cherry Paint: Carob Tambour door: Milky White Seating upholstery: Brisa® Bark Frame finish: Aluma



Reach

Statement of Line

Top Level (13"H)

Flipper Door
36"W, 42"W, 48"W
(Metal door)



Hinged Doors
36"W, 42"W, 48"W
(Landscape surface doors)



Open Shelf
36"W, 42"W, 48"W



All models available full depth or 2/3 depth with 1/3 depth open shelf on reverse side. 43"H configurations limited to open shelf, top level.

Middle Level (26"H)*

Tambour Door/Shelves
36"W, 42"W, 48"W
(Choice of four door finishes)



Open Shelves
36"W, 42"W, 48"W

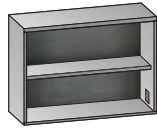

All models available with optional roll-out shelf and side shelves. *Middle level modules for use with Concensys® are 22" high.

Bottom Level (30"H)

Open Shelves
36"W, 42"W, 48"W

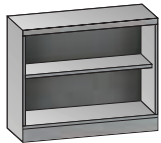

Lateral/Lateral
36"W, 42"W

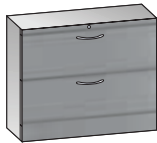

**File/Box/Box/
Lateral**
36"W

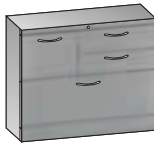

**Lateral/Lateral/
Door**
42"W, 48"W

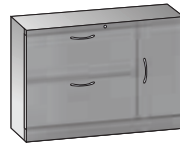

**File/Box/Box/
Lateral/Door**
42"W, 48"W



Drawers and doors offered in reversed configurations.

Wardrobe Units (56"H, 69"H)

Wardrobe
56"H, 69"H | 24"W
(Two-sided, 1/2 depth)

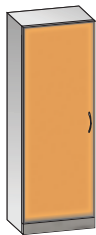

Wardrobe door available as metal or Landscape surface.

Integrated Wardrobe
File/Box/Box/Lateral/Wardrobe
56"H | 42"W, 48"W

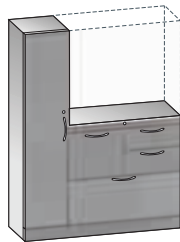

Tambour door or open shelves are specified at the middle level on integrated wardrobe models. Wardrobe can be placed on the left or right.

Integrated Wardrobe
Lateral/Lateral/Wardrobe
56"H | 42"W, 48"W

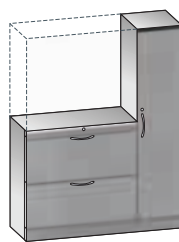

Worksurfaces

These fundamental shapes can be used alone or in combination to create the most functional worksurfaces.

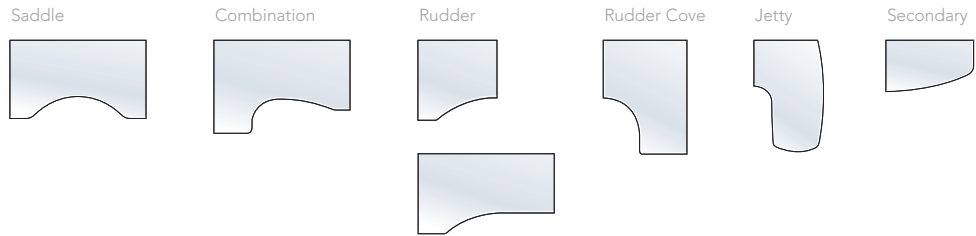

Worksurface-Saving Work Tools

Be sure to see the Extensions brochure for more information on these and many other work tools that further free up worksurface space.

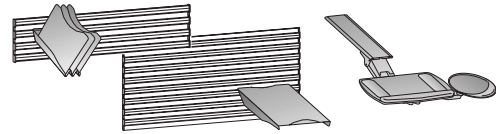

Mix-n-Match

Create your foundation wall in any number of heights, widths, and storage configurations to meet individual needs and space-planning requirements.

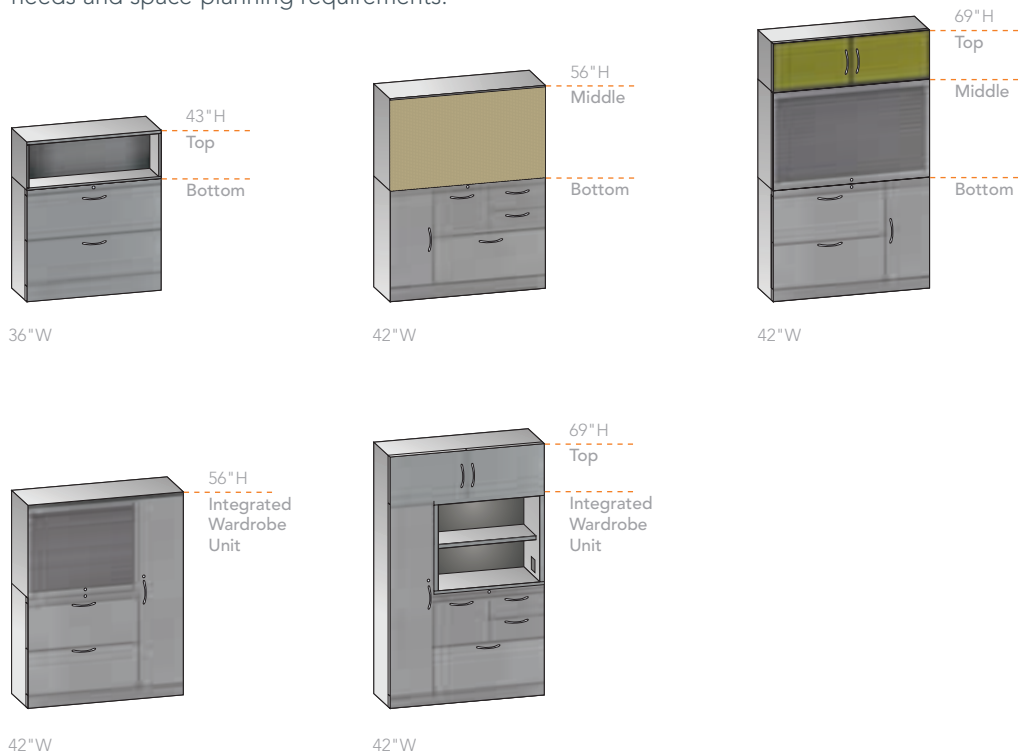

Heights are nominal.

Reach

Reach is a response to the many challenges facing facilities managers and employees: rising rents and decreasing space, overcomplicated ordering and inventory, increasing demands for paper storage along with power and data access, and the ongoing need for better organizational methods and improved workflow systems. Working with Cortet Studio, the Allsteel research, design, development, and manufacturing teams created this innovative integrated storage solution that facilitates organization and efficiency and maximizes space-planning opportunities. And we made sure it looks great, too.

For more information, please visit allsteeloffice.com.

Respecting the environment.

At Allsteel, we help our business partners achieve a positive environmental impact and understand that environmental stewardship benefits us all. We ensure that all materials balance performance and sustainability. Relevant, durable, high-quality products guarantee years of use and re-use.

Reach efficiencies have a positive influence on the environment far beyond the individual office. Reach's material intensity rate is 14% less than the typical workstation. This means there's significantly less embodied energy in each workstation, and it reduces the environmental impact of manufacturing. You can further improve the environmental equation by choosing 6' x 8' workstations over 8' x 8' and reduce building energy costs by 25% per office. This translates to saving 2,203 kilowatt hours* and eliminating 2.4 tons of greenhouse gases from power generation per year. And since Reach allows you to use lower panel walls, you can rely on more daylight for illumination, reducing your electric bill while improving the environment inside and outside the office.

Reach is an SCS Indoor Advantage™ certified product.

*Based on national average costs provided by Building Owners and Managers Association International.

Allsteel®

Designed to work. Built to last.

Allsteel Inc.
Muscatine, Iowa 52761-5257

allsteeloffice.com

Form # A7509 (05/07)

Printed in USA

©2007 Allsteel Inc.
Allsteel is a registered trademark and Adept, Cleargrain, Designed to work, Built to last, Extensions, Get Set, Infinite Spectrum, Landscape, Pearlescent Strata and Reach are trademarks.
Brisa is a registered trademark of Ultrafabrics, LLC. LEED is a registered trademark of the U.S. Green Building Council. PANTONE® and other Pantone, Inc. trademarks are the property of Pantone, Inc.

Product meets or exceeds ANSI/BIFMA performance standards for business and institutional furniture, and is backed by the Allsteel Lifetime Warranty.

